



OSPREY COURT

BARRY

OSPREY COURT

, C F 63 4J G

OFFERS OVER

£90,000 -

LEASEHOLD



1 Bed



1 Bath



495.14 sq ft

Set in a convenient location close to shops and public transport, this charming one-bedroom flat offers both comfort and privacy, with its own private entrance, no communal hallways.

Inside, the property features a bright and well proportioned reception room, a generous double bedroom, and a neatly presented bathroom. Ideal for relaxed living, the layout is practical and low-maintenance.

A standout feature is the good sized private garden, rarely found with properties of this type. Whether you're into gardening, outdoor dining, or simply want your own green space to unwind, this garden offers fantastic potential.

Perfect for first-time buyers, couples, or anyone looking to downsize without compromising on outdoor space, this well located flat is a fantastic opportunity.

HALLWAY
2'10" x 10'11"

LIVING ROOM
12'06" / 9'06" x 13'04"

KITCHEN
9'10" x 9'06"

BEDROOM
9'07" x 13'02"

BATHROOM
6'05" x 5'10"

STORAGE
5'10" x 5'06"





Energy Efficiency Rating		
	Current	Potential
Very energy efficient - lower running costs		
(92 plus) A		
(81-91) B		
(69-80) C	73	75
(55-68) D		
(39-54) E		
(21-38) F		
(1-20) G		
Not energy efficient - higher running costs		
England & Wales		EU Directive 2002/91/EC



Osprey Court, Barry, CF63 4JG

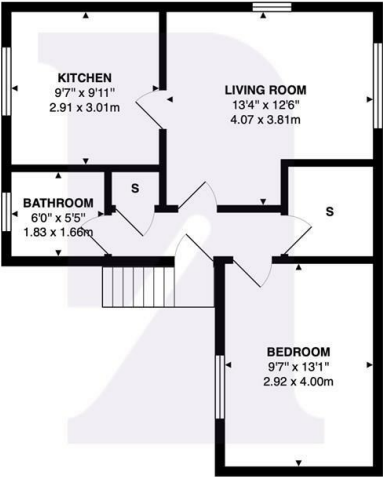

Total Area: 500 ft² ... 46.5 m²
All measurements are approximate and for display purposes only

BARRY & THE VALE'S HOME FOR

STYLISH SALES
& LETTINGS



KNIGHTS